

## Home Screen Layout

The diagram illustrates the home screen layout of the INTEGRA system, centered around a tablet device. The main screen displays the following information:

- Configuration:** Ag Leader, Waterway, South, Region: <1>
- Operation Summary:** (Empty area)
- Productivity:** -- ac/hr
- Average Speed:** -- mph
- Operating Time:** 0:00:00
- Area Complete:** 0.0 ac
- Area Remaining:** 0.0 ac
- Distance Traveled:** 0.0 ft
- Time:** 10:08:48 AM, 04/29/2010

Callouts point to the following screens:

- Grower, Farm and Field:** Field Operation Wizard: Grower Selection. Fields include Growing Season (2010 Crop), Grower (Greenpasture Farms), Farm (Jones Farm), and Field (Main Field).
- Region:** Options screen with a dropdown menu set to <1>.
- Setup:** Configuration screen for JD 8130 Ripper, showing Equipment Name (JD 8130), Vehicle (JD 8130), and Implement (Ripper).
- Report Details:** Report Details screen with a table of attributes and values.
- External Storage Operations:** External Storage Operations screen showing storage status (Used: 0.5 MB, Free: 244.1 MB, Total: 244.6 MB) and buttons for Copy Data, Upgrade Firmware, Import Files, Export Files, and Manage Files.
- Summary Report:** Summary Report screen showing a table of instances with columns for Region, Area (ac), and Date Created.

## Map Screen Layout

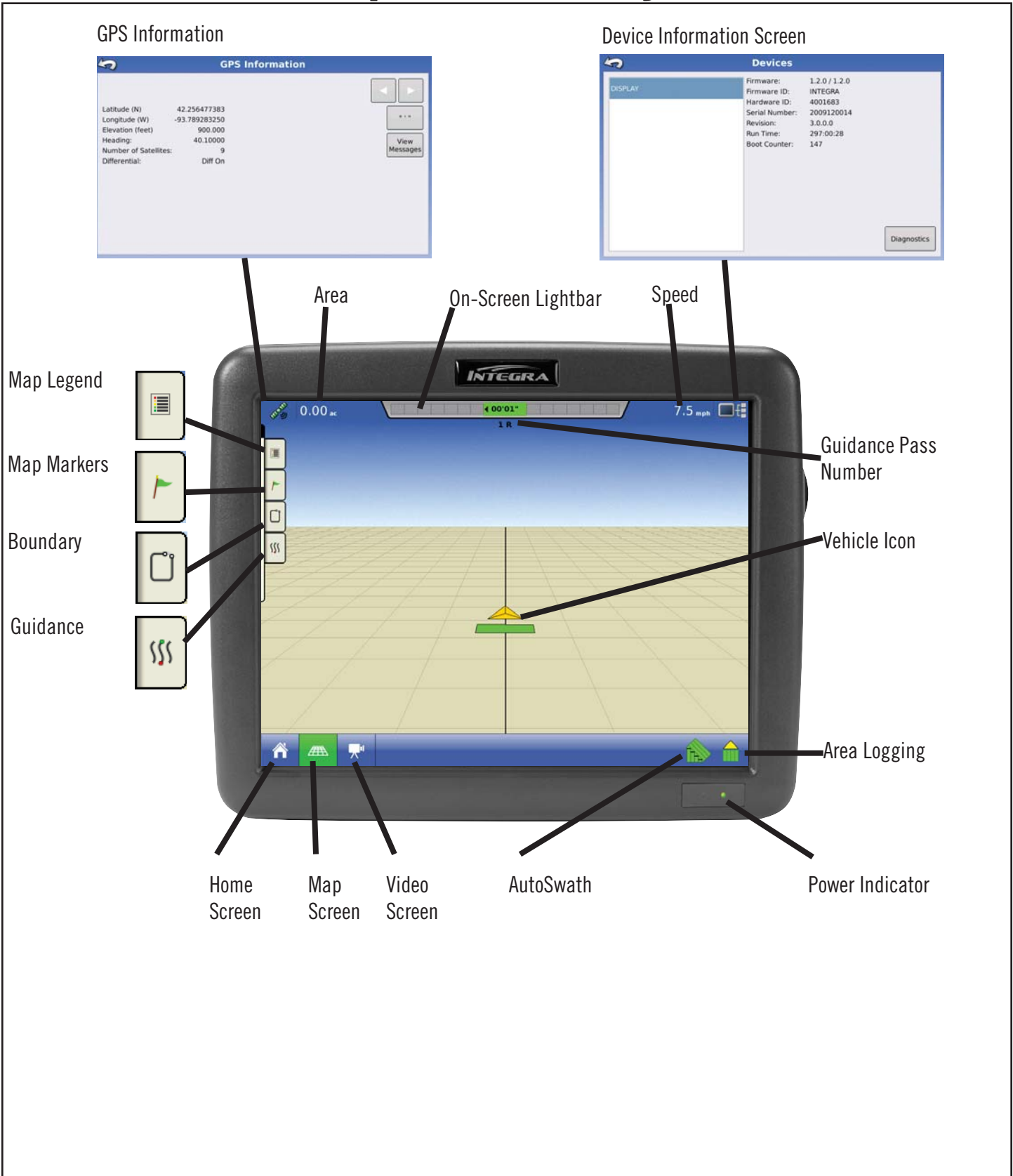

## Connecting the System

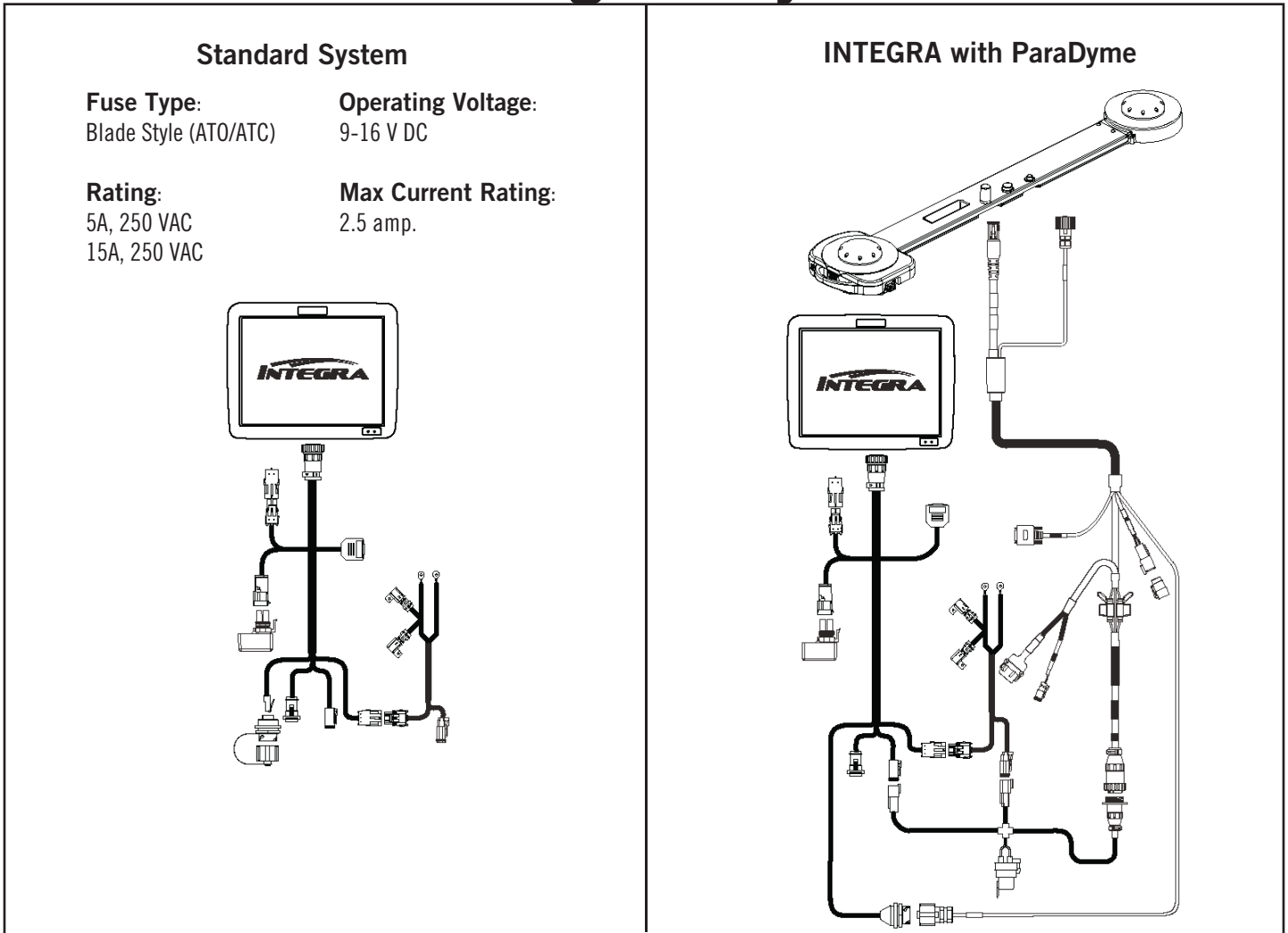

## Mounting the System

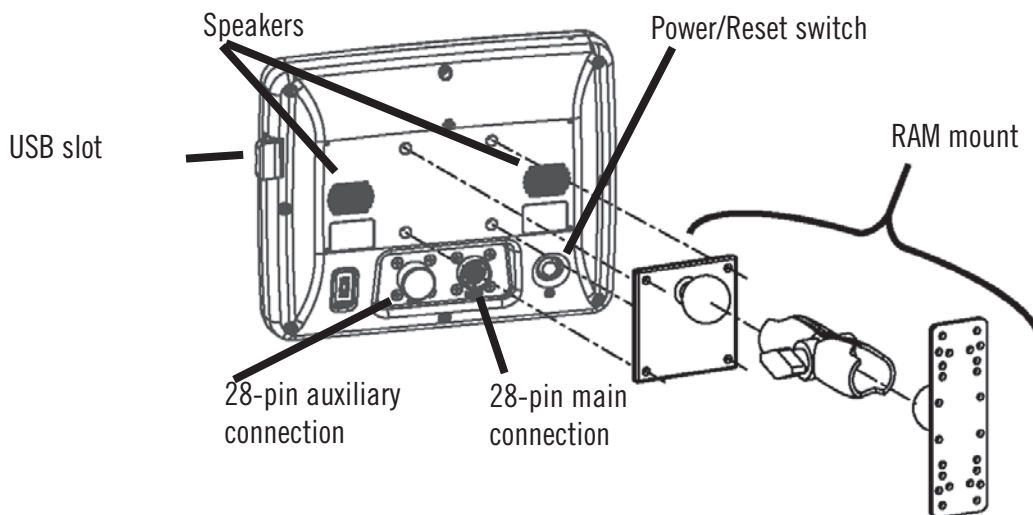

## Status Bar Icons

|  |  |  |                                 |
|--|--|--|---------------------------------|
|  |  |  | GPS Button                      |
|  |  |  | Flex Mode (ParaDyme users only) |
|  |  |  | Device Information Button       |

## Task Bar Buttons

|  |  |  |                      |
|--|--|--|----------------------|
|  |  |  | Home                 |
|  |  |  | Map View             |
|  |  |  | Steering Status      |
|  |  |  | NORAC Engage Buttons |
|  |  |  | Video Screen Button  |

## Function Buttons

|  |  |                     |
|--|--|---------------------|
|  |  | Master Switch       |
|  |  | Area Logging Status |
|  |  | AutoSwath           |

## Map Screen Icons

|  |  |  |                 |
|--|--|--|-----------------|
|  |  |  | Vehicle Icons   |
|  |  |  | Arrow Icons     |
|  |  |  | Zoom Tool Icons |

## Setup Buttons

|  |                       |
|--|-----------------------|
|  | Setup (wrench) Button |
|  | Add Button            |
|  | Remove Button         |
|  | On-screen keyboard    |
|  | Configuration Setup   |
|  | Management            |
|  | GPS                   |
|  | Console               |

## Guidance

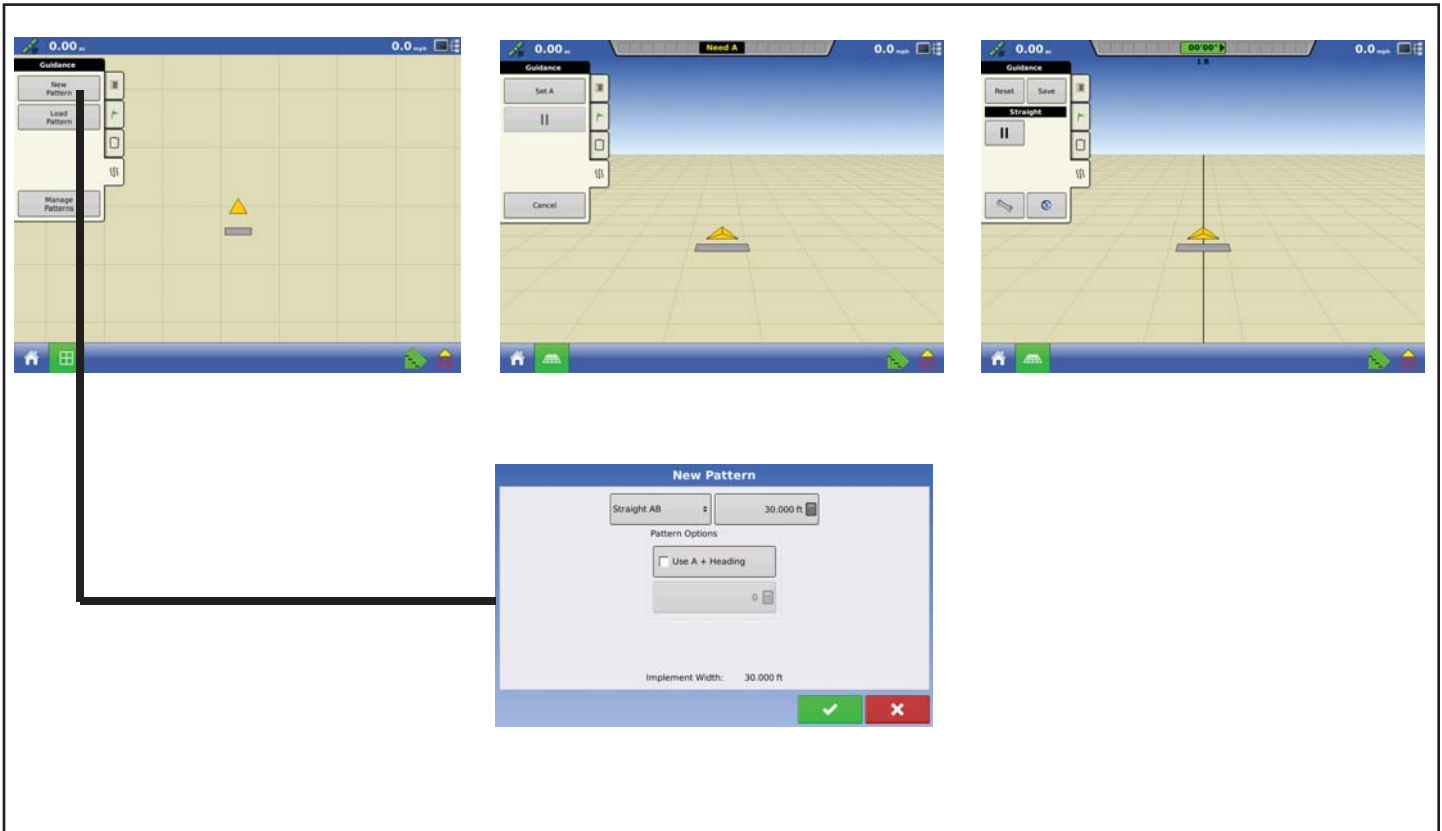

## Harvest

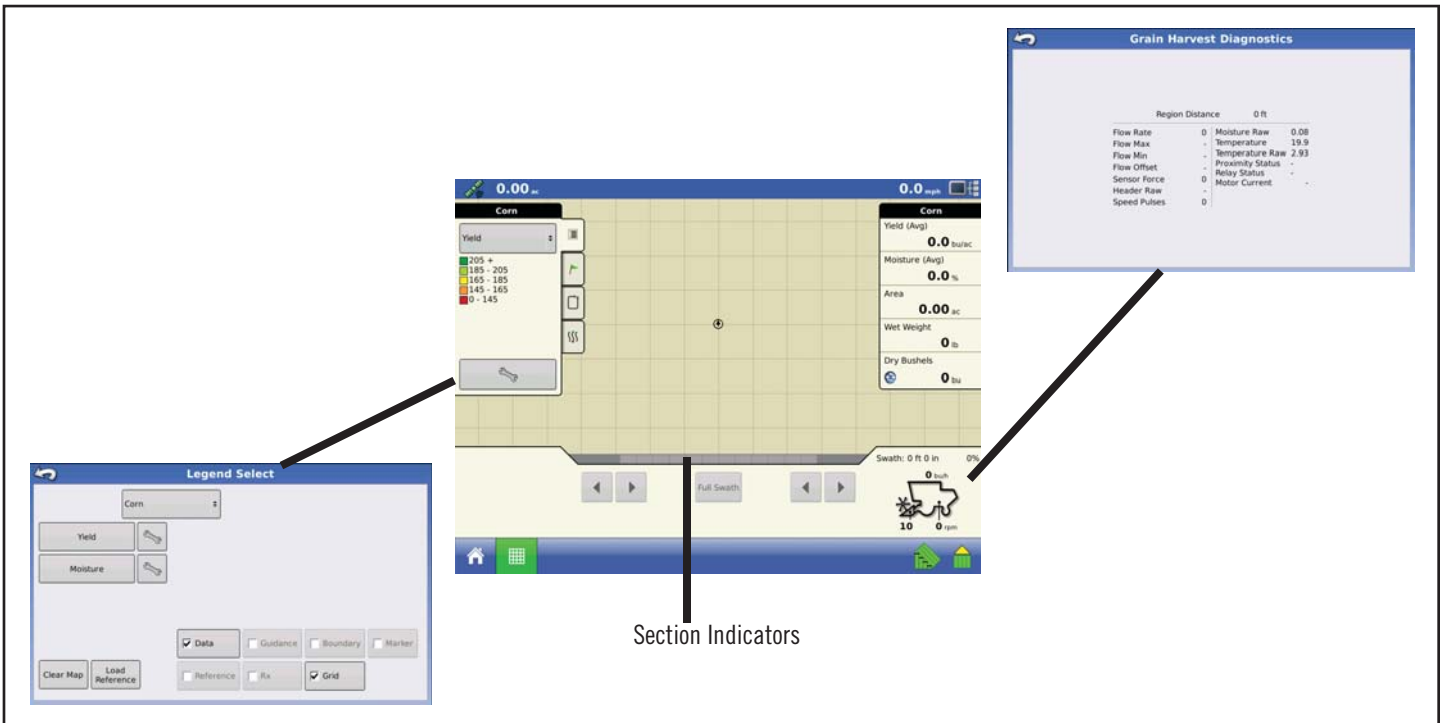

## Planting (SeedCommand™)

The interface is divided into several functional panels:

- Legend Select:** A panel for selecting crop types and map layers. It includes a dropdown for 'Soybeans', buttons for 'Varieties' and 'Rate', and checkboxes for 'Data', 'Guidance', 'Boundary', 'Marker', 'Reference', 'Rx', and 'Grid'. 'Data' and 'Grid' are currently checked.
- Rate Control Settings:** A panel for configuring seeding rates. It features a 'Soybeans' dropdown, input fields for 'Rate 1' (32000), 'Rate 2' (30000), and 'Increment' (1000). It also includes a 'Prescription' button, a 'Minimum Flow' field (0), and a 'Full: Current:' status indicator.
- Seed Monitor Options:** A panel for configuring the seed monitor. It has 'Display Options' (Table View) and 'Rate / Spacing Display' (Scan, Freeze, Planter). It shows 'Averages' for 'High Row' (1: 27900) and 'Low Row' (1: 27900), and a 'Gain' field (1). An 'Alarms' section has a checked option 'Ignore seed alarms when row clutches turn off'.
- Planter Controls:** A panel for meter calibration. It includes a 'Meter Calibration' section with a 'Soybeans' dropdown and a '0 sds/rev' field, and a 'Calibrate' button. A 'Seed Meter Prime' button is also present.

The central main display shows a map with a grid, a 'Soybeans' rate of 32000 sds/ac, and a 'Planter Average' of 27900 sds/ac. It also displays 'Swath: 0 ft 0 in 0%' and 'Planter Drives (rpm)' for drive 1 at 31 rpm. A 'Section Indicators' label points to the bottom of the map area.

## DirectCommand™ Liquid

The interface is divided into several functional panels:

- Legend Select:** A panel for selecting the active liquid (currently 'Water') and configuring map display options. It includes a 'Rate' button, checkboxes for 'Data', 'Guidance', 'Boundary', 'Marker', 'Reference', 'Rx', and 'Grid', and buttons for 'Clear Map' and 'Load Reference'.
- Rate Control Settings:** A panel for configuring application rates. It shows 'Rate 1' (12.00), 'Rate 2' (10.00), and 'Increment' (2.00). It also displays 'Full' (1200 gal) and 'Current' (1200 gal) tank levels, a 'Prescription' button, and 'Minimum Flow' (0 gal/min). A yellow tank level indicator is shown on the right.
- Map View:** The central display showing a field map with a grid. It includes a 'Water' rate selector (12.00 gal/ac) and a 'Roundup' rate selector (28.000 fl oz/ac). A 'Section Indicators' label points to the map's section lines. The bottom of the map shows 'Injection' controls (Mode: Crop, Target Height: 30 in, Sensitivity: 5) and 'Pressure (PSI)' readings (Main: 52, Agitation: 27, Auxiliary: 35).
- Injection Controls:** A panel with 'DirectInjection' status and 'Prime' and 'Agitate' buttons, along with a green checkmark button at the bottom.
- Boom Height Control Options:** A panel for adjusting 'Crop Mode', 'Sensitivity' (set to 5), and 'Target Height' (set to 30).

## DirectCommand™ Dry

The interface is divided into several functional areas:

- Legend Select:** A panel for configuring map layers. It includes a 'DAP' dropdown, a 'Rate' button with a wrench icon, and checkboxes for 'Data', 'Guidance', 'Boundary', 'Marker', 'Reference', 'Rx', and 'Grid'. 'Data' and 'Grid' are currently checked. 'Clear Map' and 'Load Reference' buttons are also present.
- Rate Control Settings:** A panel for setting application rates. It features a 'DAP' dropdown, input fields for 'Rate 1' (50.00), 'Rate 2' (40.00), and 'Increment' (10.00). It also includes a 'Prescription' button with a green arrow and a 'Minimum Flow' field set to 0. On the right, a yellow map preview shows a 15 ft³ container with 10% remaining. 'Full:' and 'Current:' indicators both show 150 ft³.
- Central Map:** The main application area showing a field map with a grid. The top status bar displays '0.00 ac' and '0.0 mph'. A 'DAP' dropdown is at the top left. A legend on the left shows rate ranges: 55.0+, 45.0-55.0, 35.0-45.0, 25.0-35.0, and 0-25.0. A right-side panel shows 'DAP' (50.00), 'MAP' (40.00), and 'Urea' (60.00) rates, along with 'Flow', 'Applied', 'Area', and 'Container' metrics. At the bottom, 'Section Indicators' (1, 2, 3) and 'RPM' are visible.
- Spreader Control:** A panel for managing the spreader. It includes 'Spread Width' (60 ft) and 'Spinner Speed' (600 rpm) controls. Below are 'Chain Oiler', 'Static Calibration', and 'In-Field Calibration' buttons. The main section shows 'Channel 1', 'Channel 2', and 'Channel 3' settings for 'DAP', with 'Product Density' (58 lb/ft³), 'Feed Gate 1 Opening' (2 in), and 'Conveyor 1 Rate' (0.256 ft³/rev) displayed.



## Configuration Setup Settings - 1

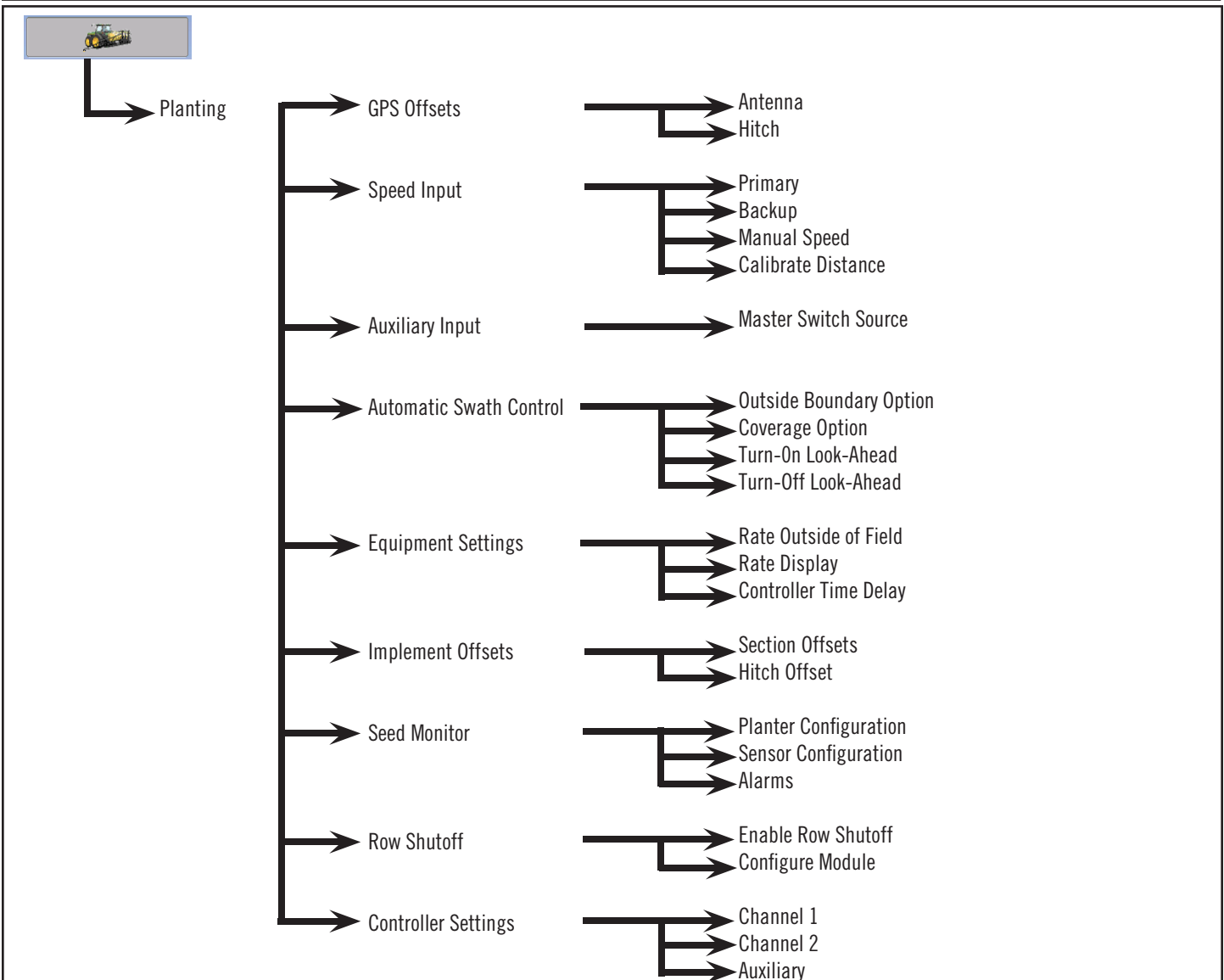
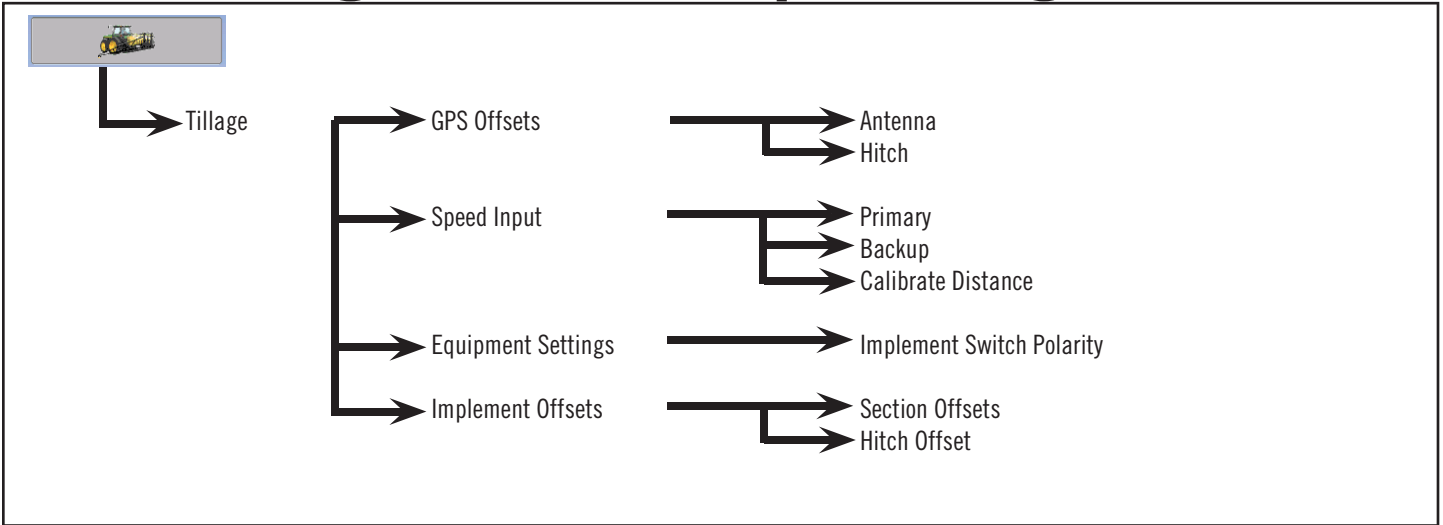

## Configuration Setup Settings - 2

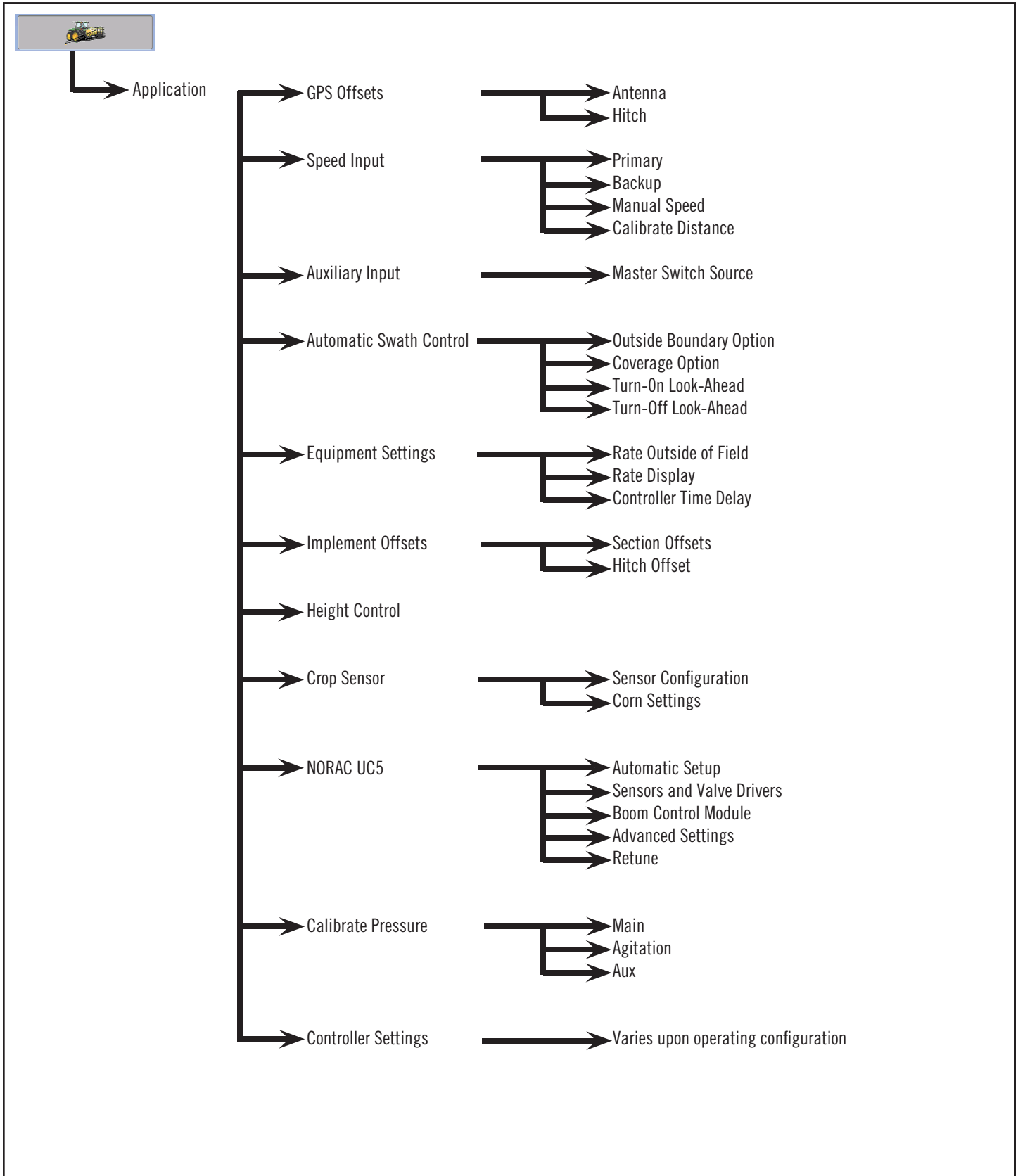

# Configuration Setup Settings - 3

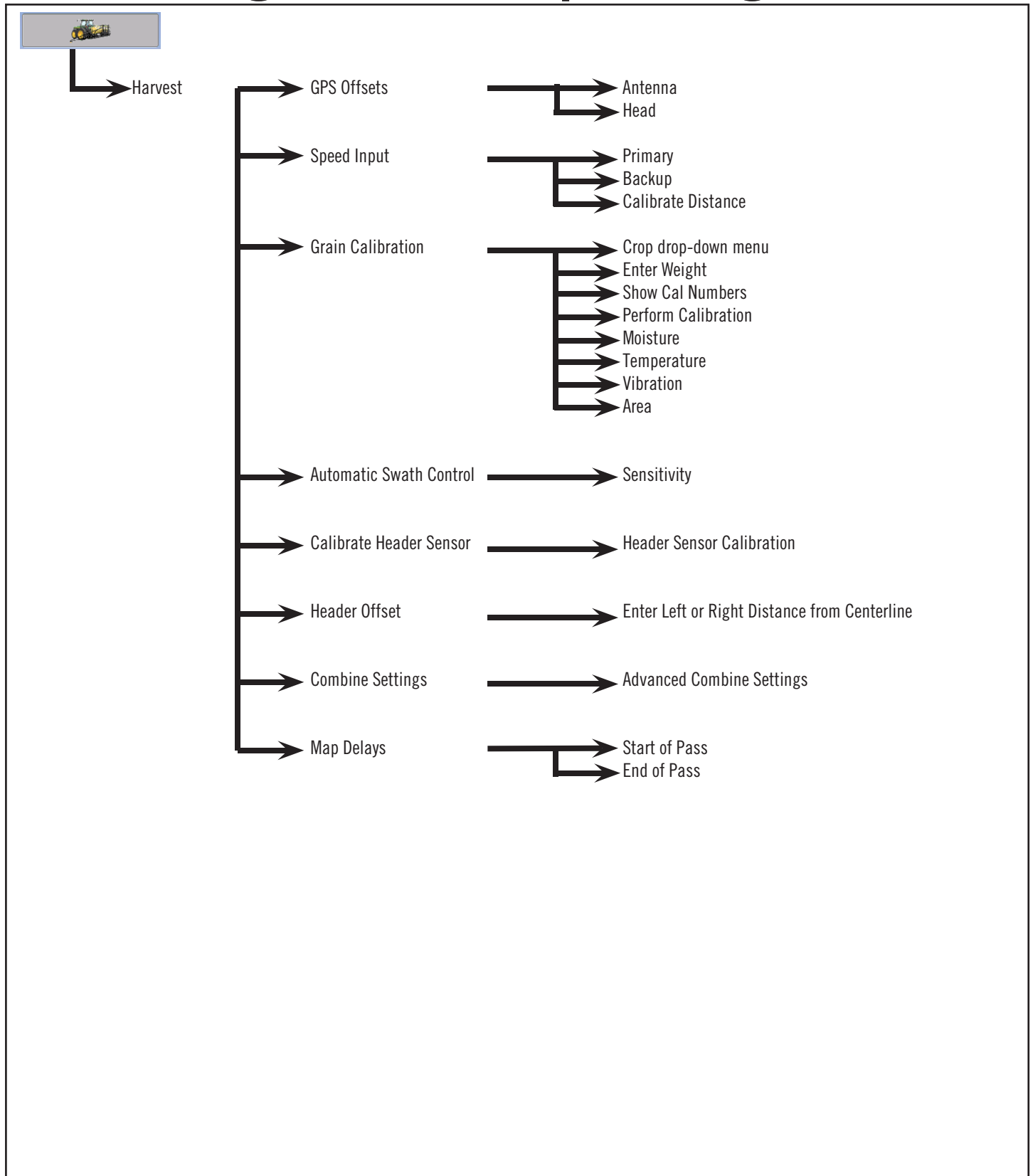

## Management Setup Settings

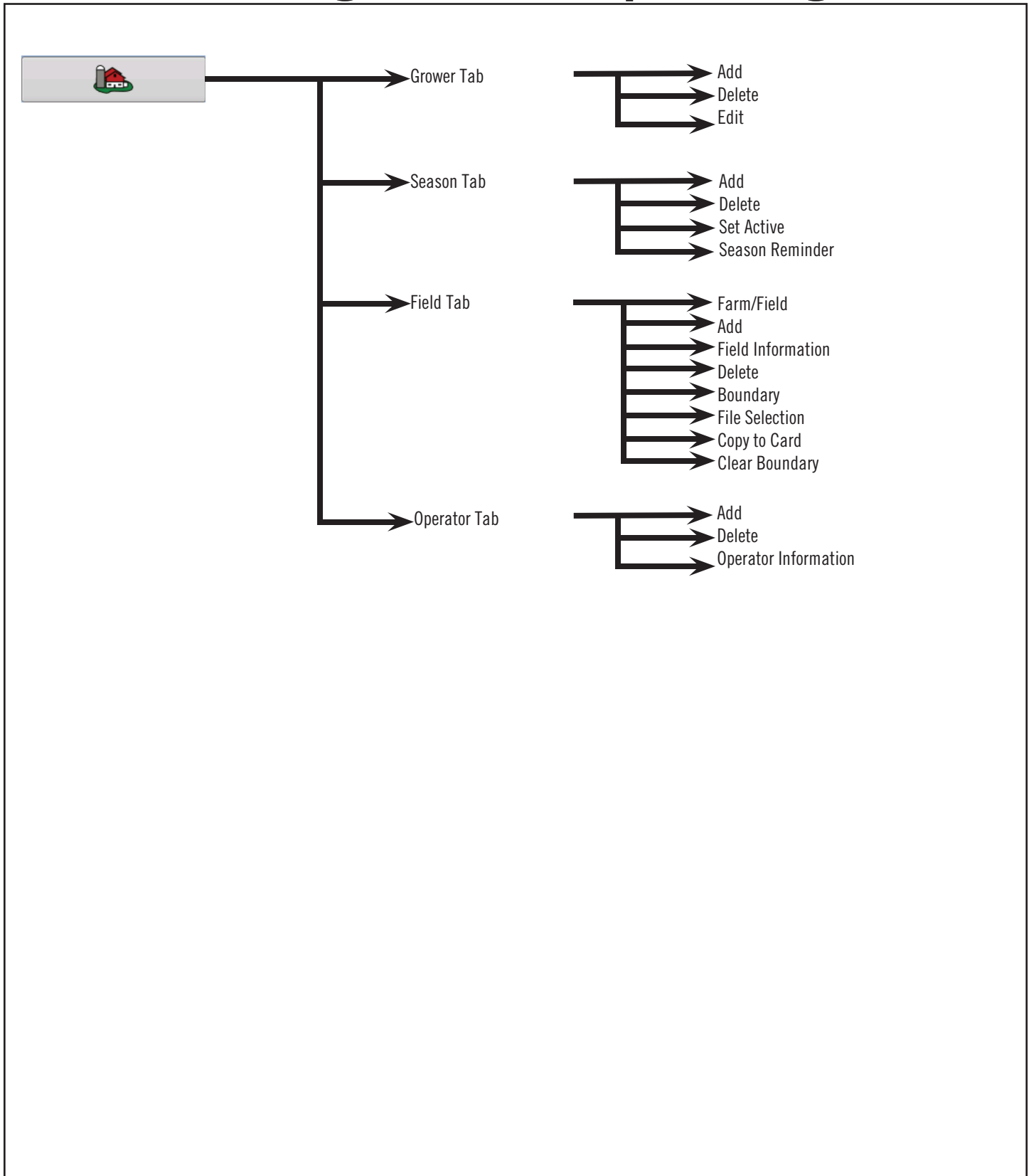

## Console Setup Settings

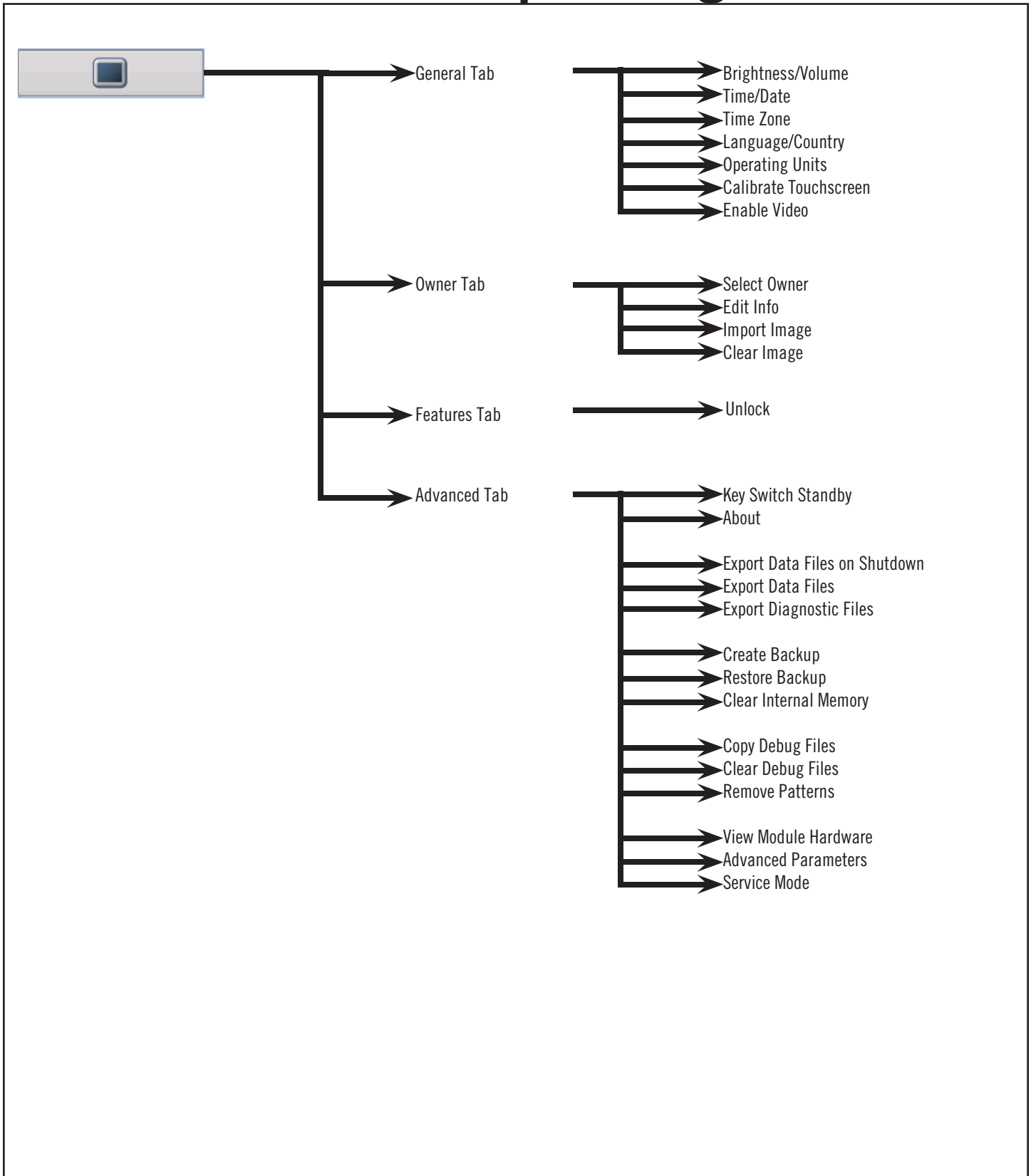

# GPS Setup Settings

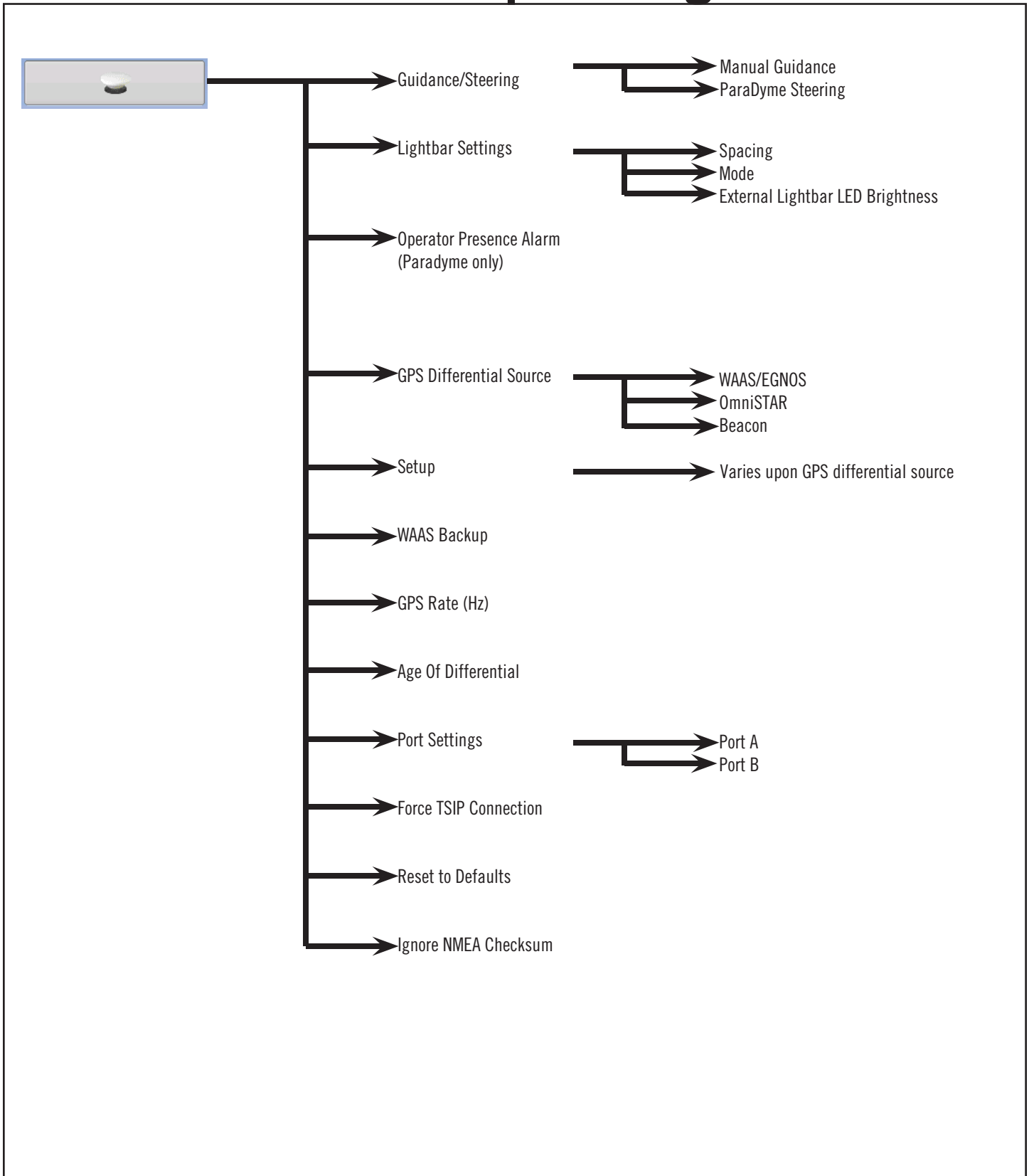

## Home Screen Setup Menus

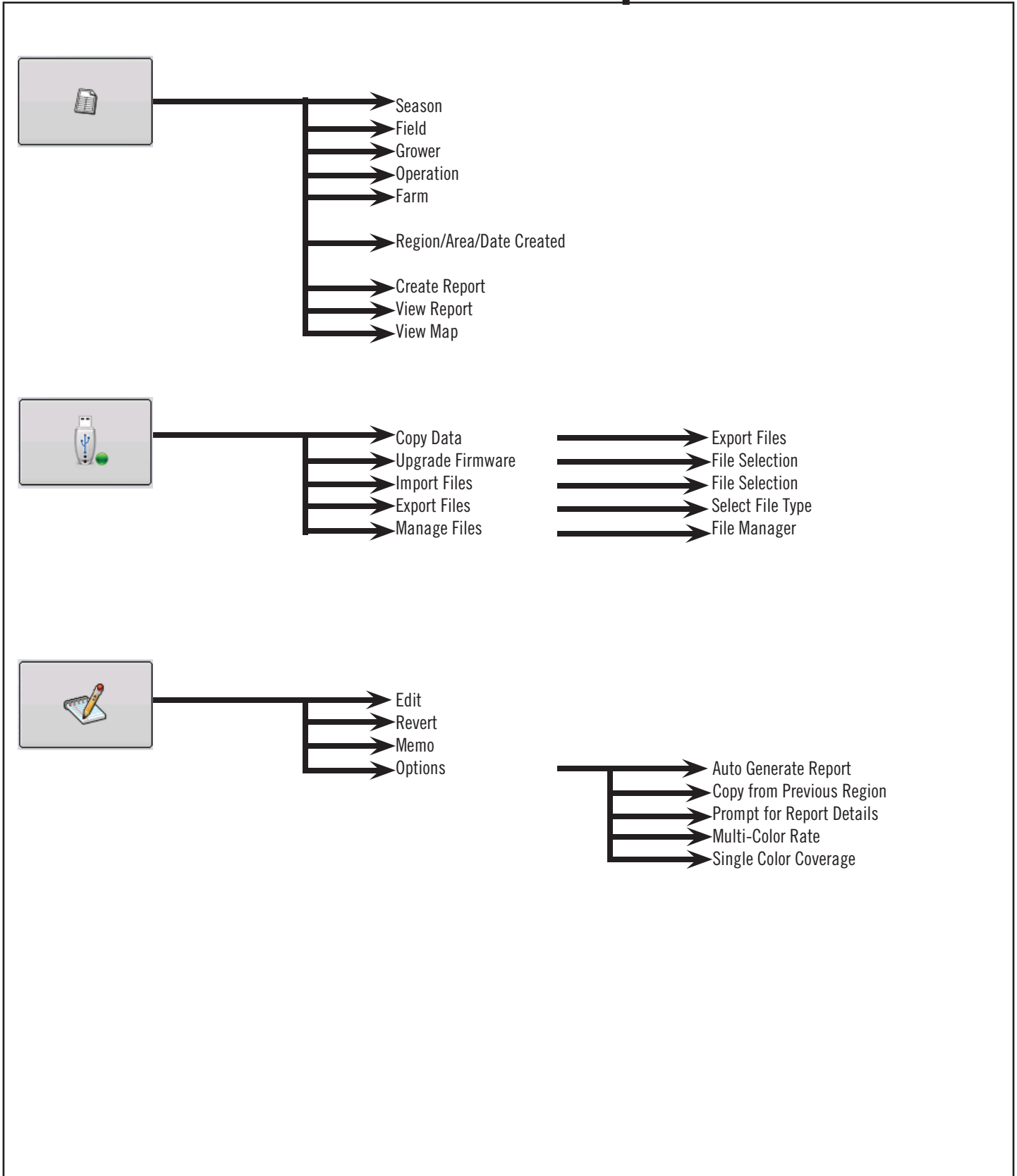

## Safety Notice

Read these safety instructions and the User Manuals thoroughly, and follow the instructions.

- Only an operator who is fully authorized to drive the vehicle can use the OnTrac2 GPS Assisted Steering System and/or the ParaDyme system.
- The operator must not exceed the safe speed limit for the terrain on which the vehicle is operating.
- The operator must always be aware of his actions when operating the OnTrac2 GPS Assisted Steering System and/or the ParaDyme system.
- When installing the OnTrac2 GPS Assisted Steering System and/or the ParaDyme system do not force the components as this can result in damage to the components.
- Always follow the instructions in the installation, operation, and maintenance manuals.
- Only trained personnel should install the OnTrac2 GPS Assisted Steering System and/or the ParaDyme system.
- Always inventory the components delivered to ensure all the correct components are present. Never use replacement components. Only use original components.
- If there are any questions regarding the safe operation of the OnTrac2 GPS Assisted Steering System and/or the ParaDyme system or the instructions in the manuals, immediately contact your authorized dealer or technical support.
- Always use the correct tools to install the OnTrac2 GPS Assisted Steering System and/or the ParaDyme system.
- To prevent injury, use caution when installing the OnTrac2 GPS Assisted Steering System and/or the ParaDyme system.
- Do not use or operate the OnTrac2 GPS Assisted Steering System and/or the ParaDyme system in unsafe weather conditions.
- Do not use or operate the OnTrac2 GPS Assisted Steering System and/or the ParaDyme system on unsafe terrain.
- Only an operator who is trained, experienced or authorized can use or operate the OnTrac2 GPS Assisted Steering System and/or the ParaDyme system.
- Before using the OnTrac2 GPS Assisted Steering System and/or ParaDyme system, the operator must have sufficient knowledge of how to operate the systems in a safe manner.
- When installing the OnTrac2 GPS Assisted Steering System and/or the ParaDyme system, all safety precautions must be clearly understood. If there are any loose, missing or damaged parts they should not be used.
- Before using the OnTrac2 GPS Assisted Steering System and/or the ParaDyme system verify all functions are checked and controlled to ensure they are working correctly. When there is any doubt, do not take any risks - always contact your authorized dealer or technical support.
- Before operating the OnTrac2 system and/or the ParaDyme system, verify all functions of the Operator Presence Switch to ensure it functions correctly.
- Powering the OnTrac2 system and/or the ParaDyme system ON or OFF must be done by following the correct prescribed procedures.
- If any vehicle or system function is abnormal, for example if excessive vibrations or noise occur, immediately stop the vehicle, power OFF the OnTrac2 GPS Assisted Steering System and ParaDyme system and contact your authorized dealer or technical support.
- When maintaining or cleaning the OnTrac2 system and/or the ParaDyme system, it must be completely powered OFF and are free of any electrical currents.
- The operator of the OnTrac2 OnTrac2 GPS Assisted Steering System in conjunction with ParaDyme system must read and understand all safety instructions so they can react in case of an emergency.
- The authorized dealer must always carry out maintenance or repairs on the OnTrac2 GPS Assisted Steering System and/or the ParaDyme system.
- During repair or replacement of components on the OnTrac2 GPS Assisted Steering System and/or the ParaDyme system only original components must be used.
- Operator or maintenance personnel must always wear the correct personal protection equipment when working on the OnTrac2 GPS Assisted Steering System and/or the ParaDyme system.
- Maintenance personnel must always use the recommended cleaning materials and accessories when the OnTrac2 GPS Assisted Steering System and/or the ParaDyme system is cleaned.
- Unsafe conditions or situations with the OnTrac2 GPS Assisted Steering System and/or the ParaDyme system must be reported to your authorized dealer or technical support.
- Objects cannot be placed on or in the area of the OnTrac2 GPS Assisted Steering System and/or the ParaDyme system.
- During installation, calibration, and tuning of the OnTrac2 GPS Assisted Steering System and/or the ParaDyme system the vehicle wheels may turn to the left and right. Be sure all people and obstacles are clear of the wheels before proceeding.
- Put the vehicle seat and steering wheel in the normal operating position and verify that the OnTrac2 Mechanical Drive Unit (MDU) does not interfere with any controls.
- The operator must read and acknowledge the Automatic Steering Liability Notice each time the system is powered ON.
- If there are any questions regarding the safe operation of the OnTrac2 GPS Assisted Steering System and/or the ParaDyme system or the operating instructions, contact your authorized dealer or technical support.
- The operator must keep alert for obstacles in the path of the vehicle. The OnTrac2 GPS Assisted Steering System and/or the ParaDyme system cannot identify or avoid obstacles.
- The operator must remain in the operator's chair in the vehicle while the OnTrac2 GPS Assisted Steering System and/or the ParaDyme system is engaged.
- Only use the OnTrac2 GPS Assisted Steering System and/or the ParaDyme system in an open field. The systems must be powered OFF when the vehicle is on any type of roadway.

### Liability Notice

Novariant B.V. cannot be held responsible or liable in any way for any damages and / or accidents that occur through the malfunction of the machine on which it is installed, malfunction of the machine components, machine attributes (e.g. trailers), third party interference(s) or acts of the operator outside the intended use such as prescribed by Novariant B.V.

#### COPYRIGHT NOTICE

Ag Leader Technology has copyrighted (©2010) the contents of this Reference Guide and the operating program for the INTEGRA system. No reproductions may be made without first obtaining the consent of Ag Leader Technology.